

(4) 1" Ø BOLT HOLES
EQUALLY SPACED

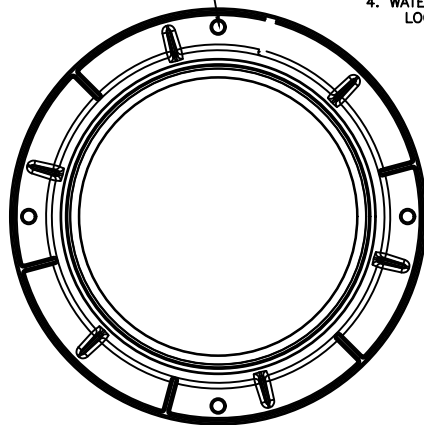

RING PLAN

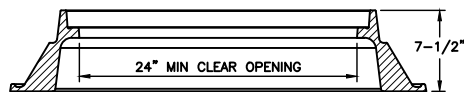

TYPE 1
RING SECTION

1. INFLOW DISHES SHALL BE INSTALLED IN SAGS
2. IN ROADWAY: USE TYPE 1 RING AND COVER AND PLACE A COLLAR OF 30000-PSI CONCRETE BENEATH THE ASPHALT TO SUFFICIENT DEPTH TO ENSURE CONTACT WITH MANHOLE
3. UNPAVED AREAS: USE TYPE 2 RING AND COVER.
4. WATERTIGHT REQUIREMENTS: USE TYPE 3 RING AND COVERS. LOCKING COVERS SHALL BE REQUIRED IN ALL OUTFALL LOCATIONS

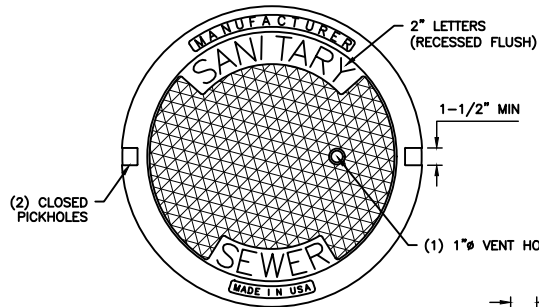

STANDARD COVER PLAN

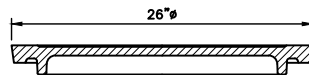

TYPE 2
STANDARD COVER SECTION

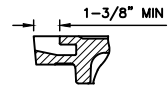

STANDARD COVER PICKHOLE DETAIL

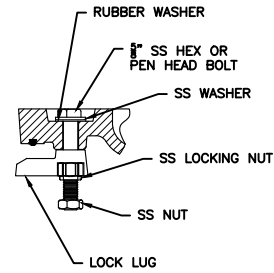

WATERTIGHT COVER LOCKLUG ASSEMBLY DETAIL

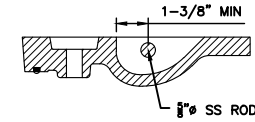

WATERTIGHT COVER PICKBAR & LOCKLUG HOLE DETAIL

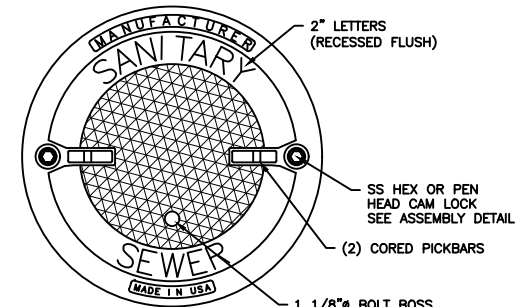

WATERTIGHT COVER PLAN

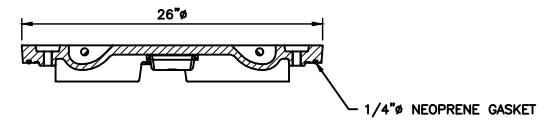

TYPE 3
WATERTIGHT COVER SECTION

EFFECTIVE: DECEMBER 15, 2017